

Special tool

Vacuum tester

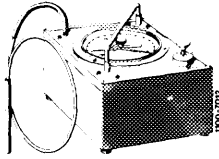

116 589 25 21 00

Conventional tool

Revolution counter

Testing EGR

1 Pull vacuum line from EGR valve (60), plug-on test hose and activate with vacuum. If operation of engine is not getting clearly worse, replace EGR valve.

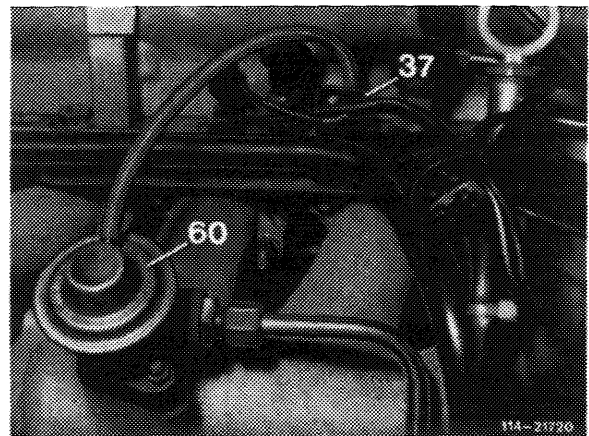

2 Check activation of EGR valve. Pull off vacuum line at EGR valve (60) and connect to vacuum tester. Increase engine speed slowly to approx. 3000 rpm. There should be no vacuum up to approx. 1800 rpm. Vacuum connections on throttle valve housing may be mixed up.

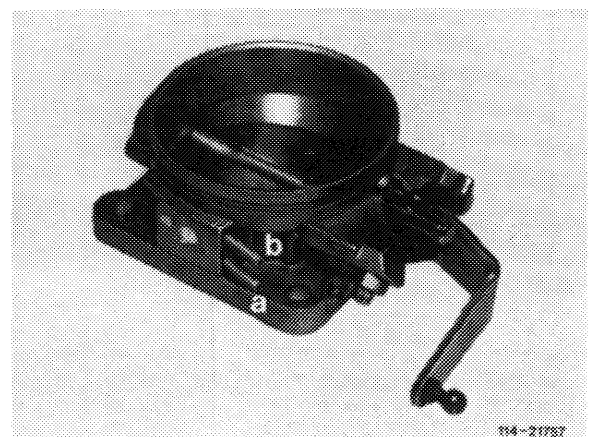

a To thermostatic valve for EGR
b To ignition distributor

3 Check thermovalve (37) 50 °C. Pull vacuum line white/brown/purple from EGR valve and activate with vacuum. At coolant temperatures < 50 °C no passage on thermovalve.

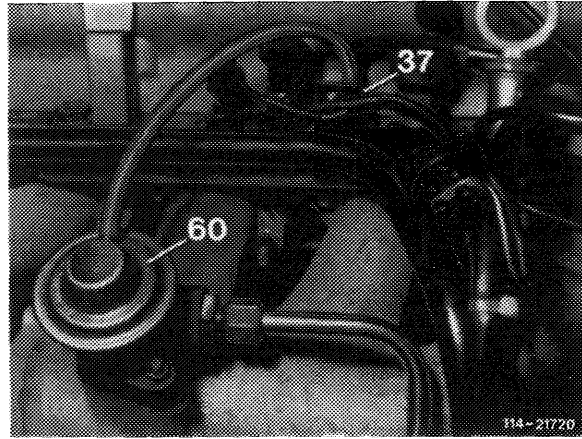

Function diagram EGR

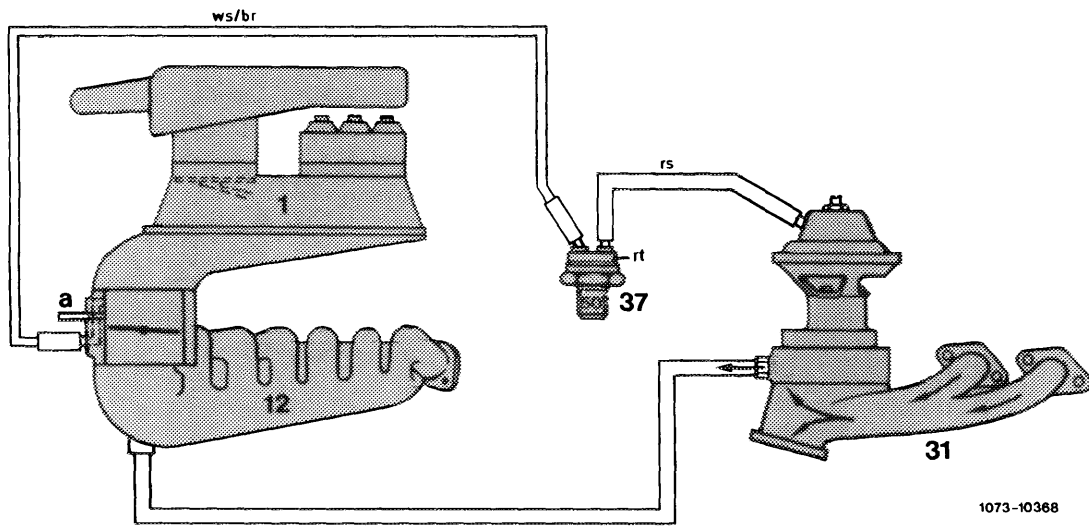

- 1 Mixture controller
- 12 Intake manifold
- 31 Exhaust manifold

- 37 Thermovalve 50 °C
- 60 EGR valve
- a To ignition distributor

Color code
 br = brown
 rs = pink
 rt = red
 ws = white

EGR

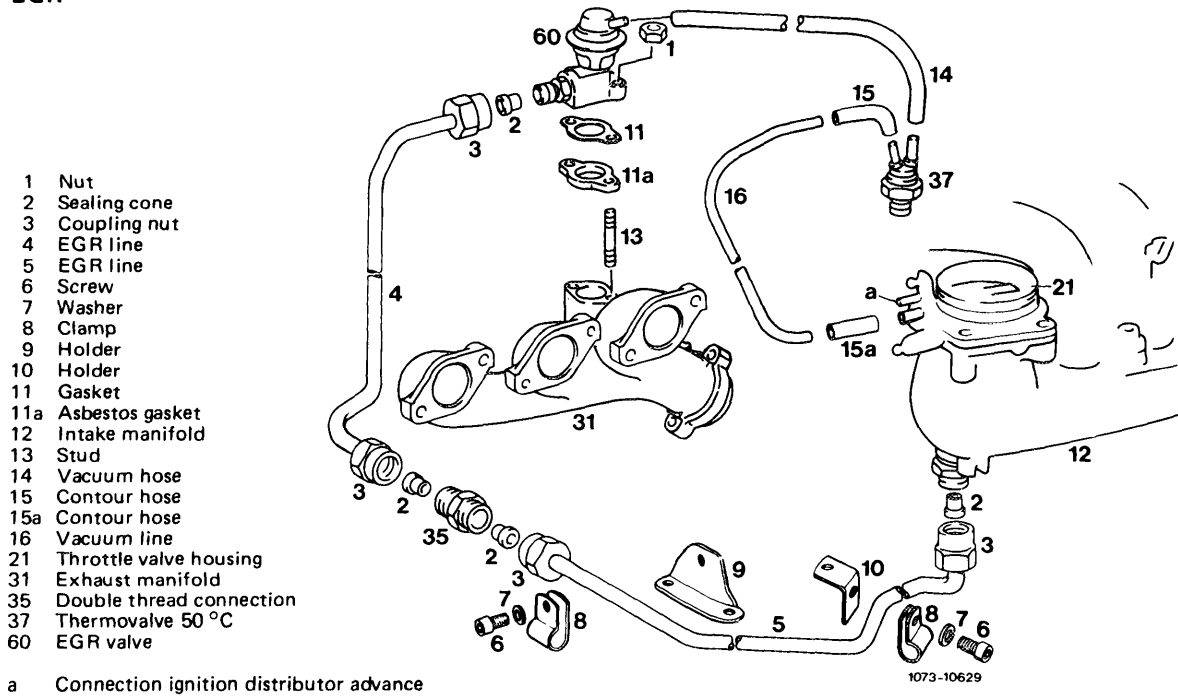

Installation: September 1981

Model	Engine	Engine end No.		Chassis end No.	
		manual transmission	automatic transmission	Installation mixed	Installation continuous
107.042	110.990			010107-011567	011569
123.007				085174-096468	096496
123.033	110.988	start of series		024129-024416	024417
123.053				010064-010252	010253
123.093					
126.022	110.989			021381-043198	043199
126.023				039922-042786	042787