

05-412 Removal and installation of intermediate gear shaft

Tightening torques	Nm
Nuts for cylinder head cover	15
Necked-down screw for camshaft sprocket	80
Fastening screw for intermediate sprocket	25
Pressure oil pump to cylinder crankcase	10

Special tools

Socket 27 mm, 1/2" square, for rotating engine		001 589 65 09 00
--	---	------------------

Impact puller (basic unit)		116 589 20 33 00
----------------------------	---	------------------

Threaded bolt M 8, 150 mm long, for impact puller		616 589 00 34 00
---	--	------------------

Threaded bolt M 6, 50 mm long, for impact puller		116 589 01 34 00
--	---	------------------

Removal

- 1 Remove intermediate gear (05-432).
- 2 Unscrew bearing bushing locking screw (arrow) and pull out intermediate sprocket shaft with front bearing bushing by means of impact puller.

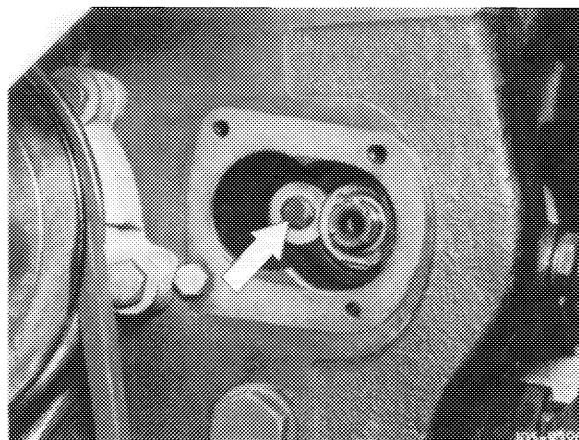

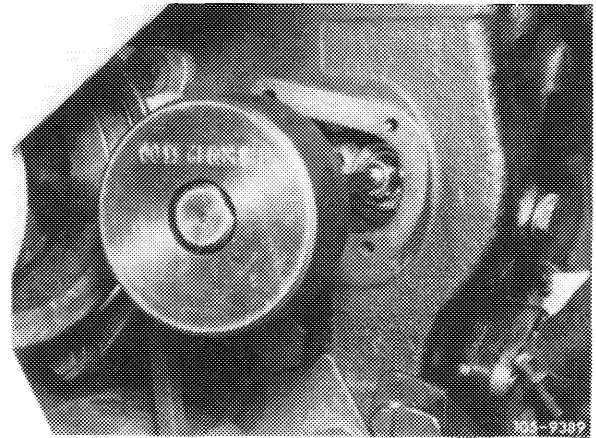

Installation

3 Insert intermediate sprocket shaft with bearing bushing. Place bearing bushing in such a manner that the lock washer is seated in recess provided so that the locking screw (Fig. item 2) can be inserted.

Tighten locking screw.

4 Install intermediate sprocket (05-432).

5 Check firing point (07.5-510).

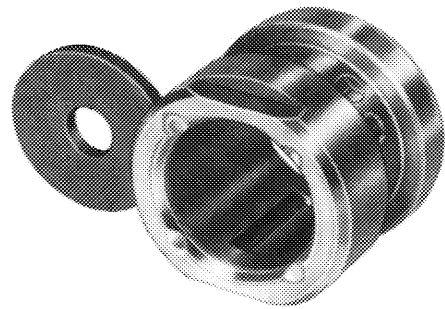

105-9509

Intermediate sprocket and helical gear shaft

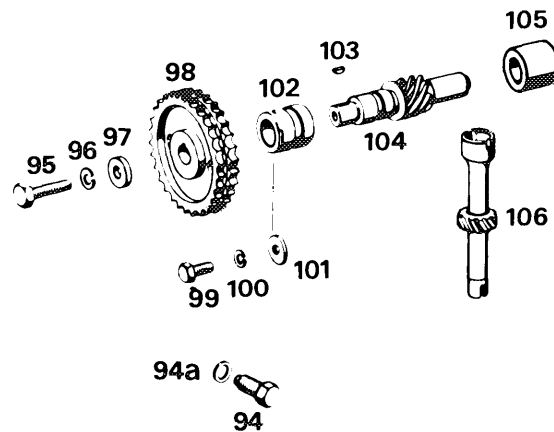
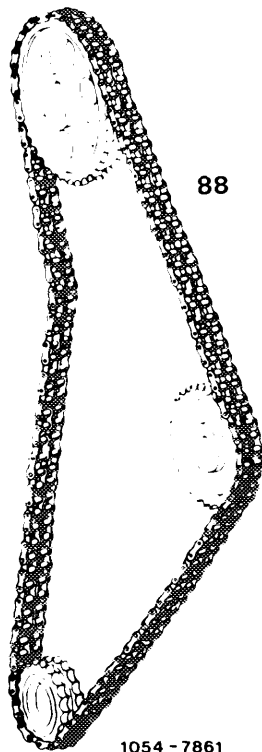

88 Timing chain
94 Chain locking screw
94a Sealing ring A 12 x 17
95 Screw M 8 x 30
96 Circlip A 8

97 Washer
98 Intermediate sprocket
99 Screw M 6 x 12
100 Circlip B 6
101 Washer

102 Front bearing bushing
103 Woodruff key 3 x 3.7
104 Intermediate sprocket shaft
105 Rear bearing bushing
106 Helical gear shaft