

47-700 Removal and installation of fuel tank

A. Model 115

Filling capacity in liters

Version	all, except (USA) starting 1975 (USA) starting 1975	
Full readout	approx. 65	approx. 78
Warning lamp reserve	approx. 9	approx. 10

Tightening torques

	Nm
Nuts for fuel tank	17-25
Nuts for fuel tank, self-locking	26-34
Fuel strainer	35-43

Special tool

Torque wrench double-arm, 1/2" square,
15-65 Nm

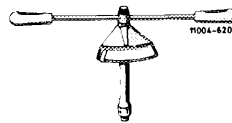

000 589 27 21 00

Attention!

When removing fuel tank, pay attention to safety rules.

Removal

- 1 Disconnect grounding line on battery.
- 2 Drain fuel tank. Carefully pump off fuel, so that no residual fuel remains in fuel tank.
- 3 Pull off coupling (1) for fuel readout.

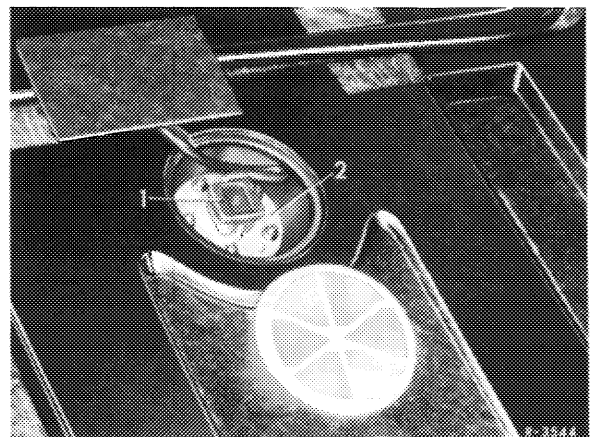

4 Loosen hose clamps (arrows) on vent lines, pull off hoses, tightly close lines and hoses.

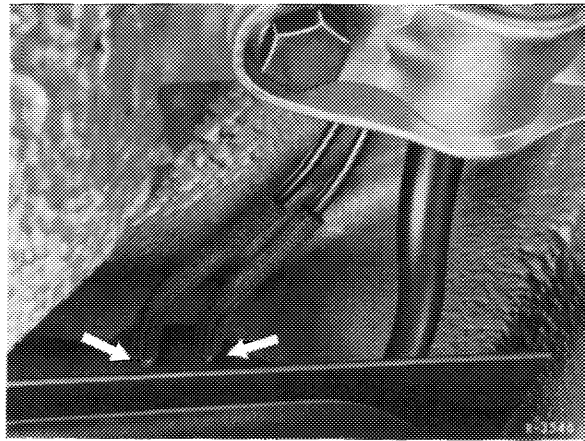

5 Loosen hose clamps on feed line (2) and return flow line (3), pull off both hoses on fuel tank and catch fuel remaining in hoses. Tightly close hoses and pipe connections.

6 Unscrew nuts (1) and remove fuel tank in downward direction.

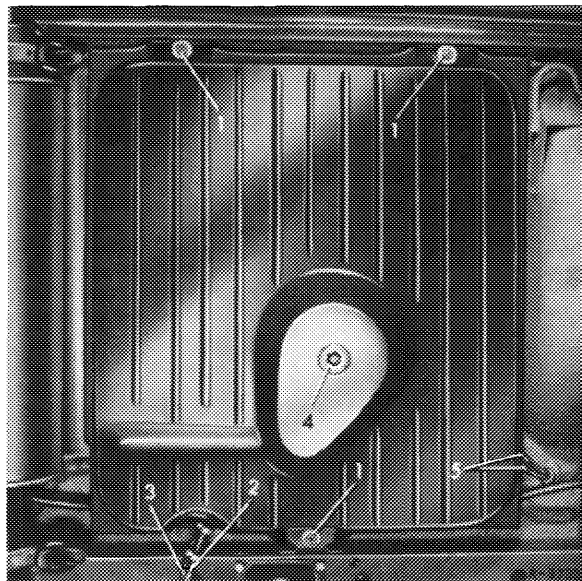

Installation

Install fuel tank in vice versa sequence. Pay attention to the following items:

7 Check whether foam rubber strips on fuel tank are tight and glue down with MB universal glue, part No. 000 989 92 71, if required.

Note: Never use felt or similar material since otherwise corrosion damage may result.

8 Remove fuel strainer. Blow out strainer jacket (b) and check for damage. Install fuel strainer with new sealing ring (a) and tighten to 35–43 Nm.

Note: The fuel strainer (b) is made of square mesh fabric of **0.1 mm width**. To prevent mixing up fuel strainer, the word „gasoline“ is punched-in on metal part.

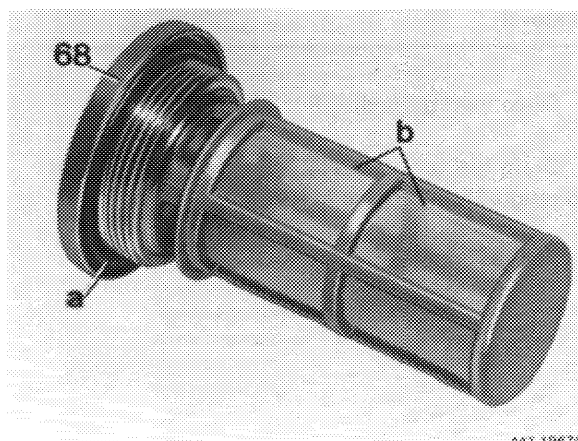

987...19678

9 Mount fuel tank with reinforcing sheet metal (1) and washers (2) provided.

If the reinforcing sheet metal is left off or if the washers are too small, fastenings on fuel tank may tear off.

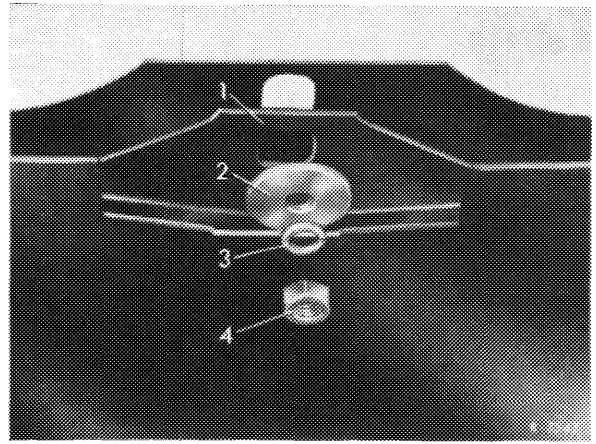

10 Tighten nuts (1) to 17–25 Nm. When using self-locking nuts, tighten to 26–34 Nm.

11 Check fuel hoses and renew, if required.

12 Connect grounding line to battery, check operation of fuel readout.

13 Check fuel system for leaks.

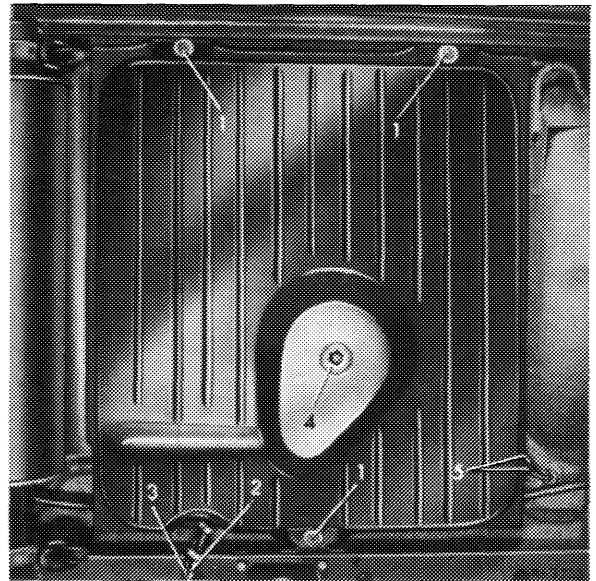

Fuel system, fuel tank positive and negative venting
Model 115

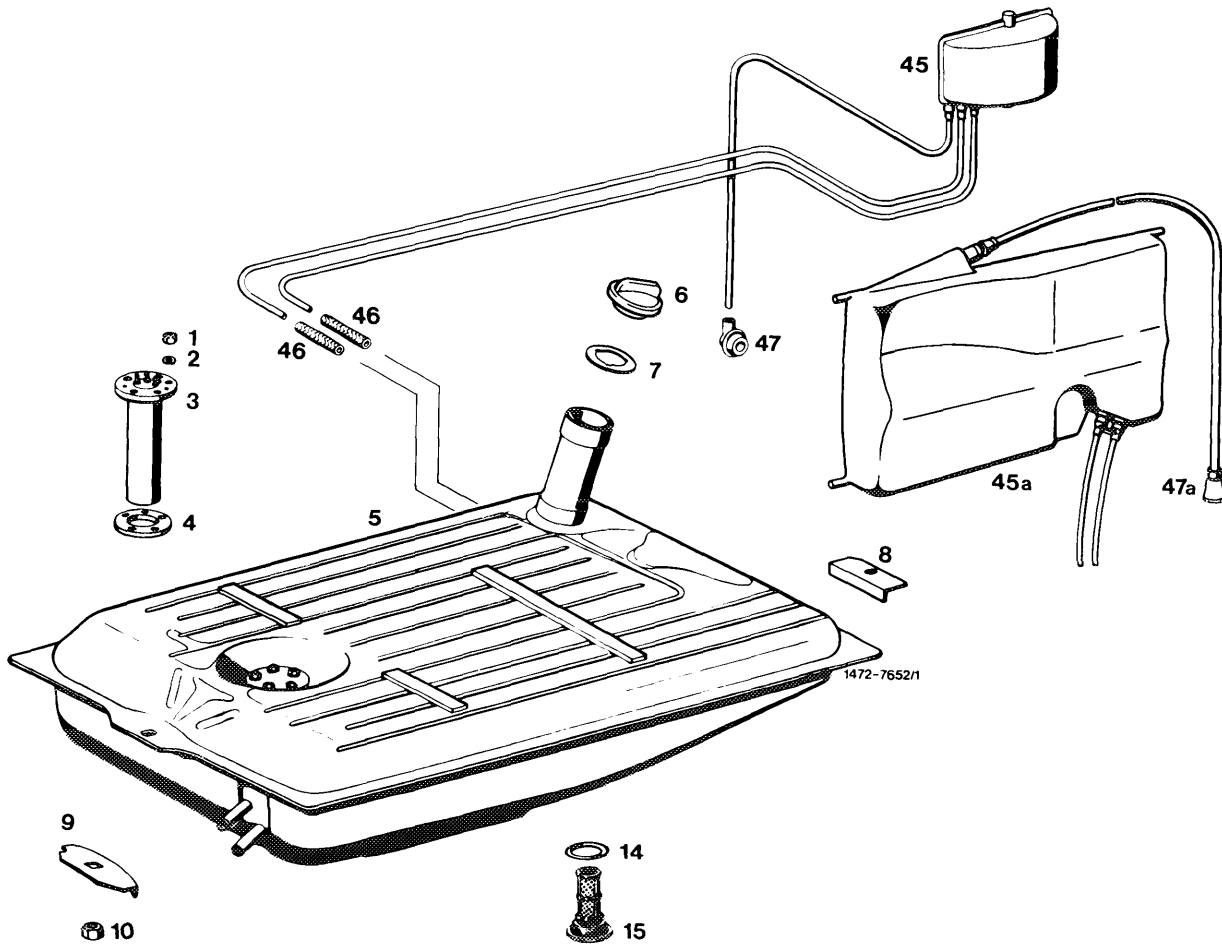

- | | |
|------------------------------|--|
| 1 Nut | 14 Sealing ring |
| 2 Spring washer | 15 Fuel strainer |
| 3 Immersion tube transmitter | 45 Fuel expansion tank |
| 4 Gasket | 45a Fuel expansion tank (special vehicles with special body) |
| 5 Fuel tank | 46 Fuel hose |
| 6 Filler cap | 47 Rubber sleeve |
| 8 Reinforcing sheet metal | 47a Protective sleeve (special vehicles with special body) |
| 9 Reinforcing sheet metal | |
| 10 Hex. nut | |

B. Model 123 sedan and coupe

Filling capacity in liters

Version	all, except USA 1977–1978	USA 1977–1978
Full readout	approx. 65	approx. 80
Warning lamp reserve	approx. 9.5	approx. 10.5

Tightening torques

Nuts for fuel tank	17–25
Immersion tube transmitter	35–43
Fuel strainer	
Suction hose	24–32

Special tool

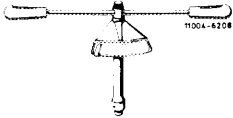
Torque wrench double-arm, 1/2" square 15–65 Nm		000 589 27 21 00
---	---	------------------

Attention!

When removing fuel tank, pay attention to safety rules.

Removal

- 1 Disconnect grounding line on battery.
- 2 Drain fuel tank. Pump off fuel carefully, so that no residual fuel remains in fuel tank.
- 3 Unscrew suction hose (arrow) on fuel tank, catch residual fuel remaining in suction hose. Tightly close fuel strainer and suction hose.

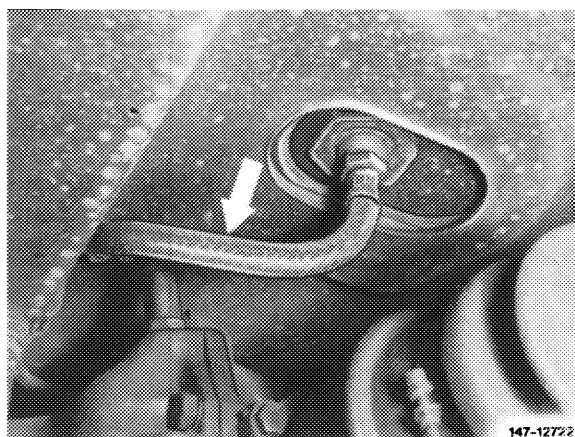

147-12722

4 Loosen hose clamps on fuel return hose and on vent hose (arrows) and pull both hoses from fuel tank. Catch residual fuel and tightly close both hoses and pipe connections.

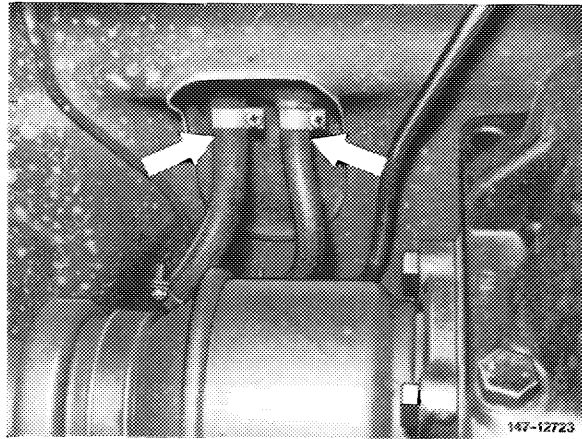

5 Remove trunk floor mat.

6 Loosen rear wall screws and remove rear wall (arrow).

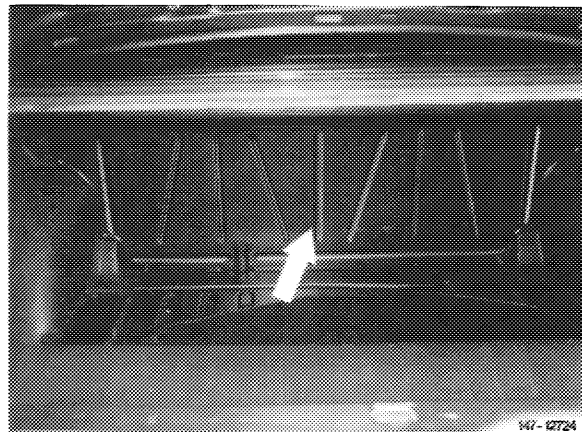

7 Unscrew nuts (arrows). Pull coupling (1) for fuel readout from immersion tube transmitter. Remove fuel tank.

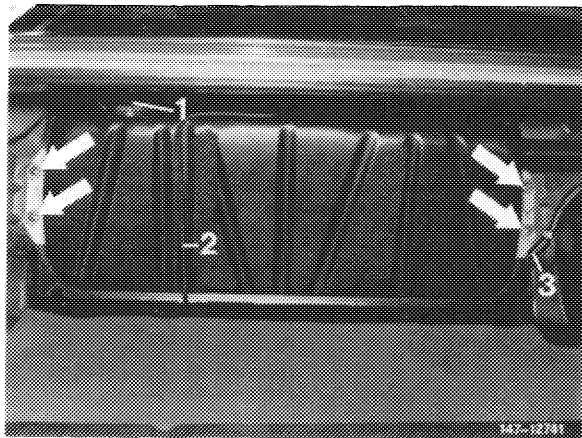

Installation

8 Install fuel tank in vice versa sequence, while proceeding as follows:

a) Glue down both gaskets on underside of fuel tank with MB universal glue, part No. 000 989 92 71. For installation, coat both gaskets on sealing surface or bead with slide compound (talcum, wax or the like).

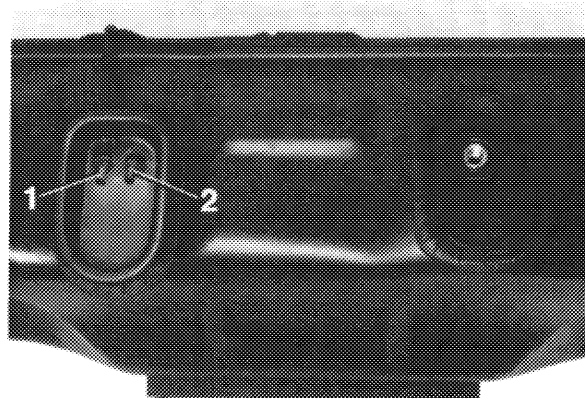

- 1 Positive and negative vent line
- 2 Fuel return line

b) Check whether foam rubber strips on fuel tank are tight and glue down with MB universal glue, part No. 000 989 92 71, if required.

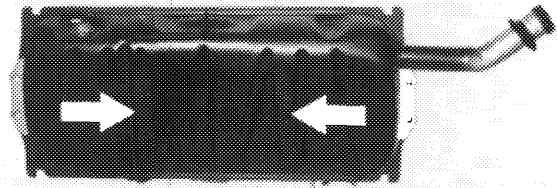

147-16857

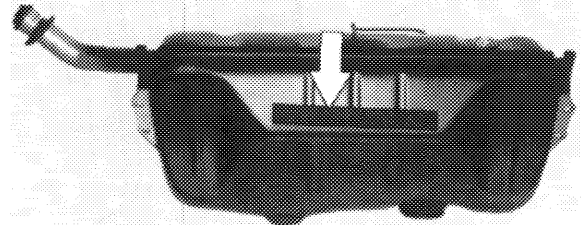

147-16856

c) Remove fuel strainer (68). Blow out strainer (b) and check for damage. Renew sealing ring (a). Tighten fuel strainer (68) to 35–43 Nm.

d) Mount fuel tank with reinforcing sheet metal parts and washers provided. Tighten fastening nuts to 17–25 Nm.

e) Pay attention to correct seat of rubber sleeve on fuel filler neck.

f) Plug on coupling for fuel readout and check for correct operation (grounding line on battery connected).

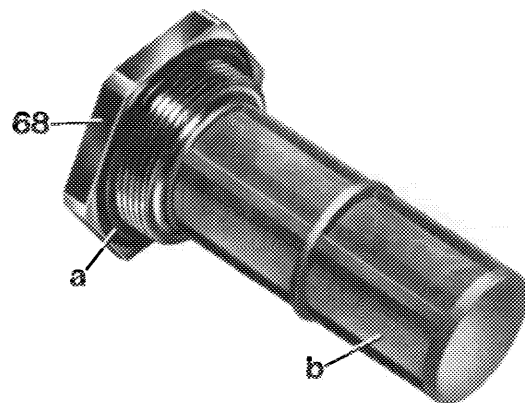

147-17012/1

g) Check seal between fuel tank and trunk floor and seal again, if required. For this purpose, carefully apply Unionzement from underside of vehicle at circumference of opening (arrows), using a brush or the like.

h) Check fuel system for leaks.

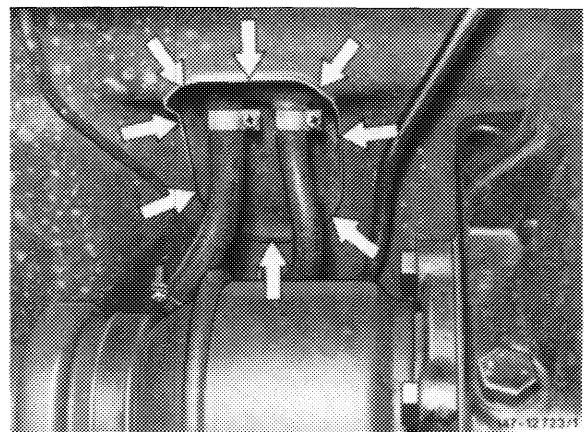

147-12723/1

Fuel system, fuel tank positive and negative venting
 Model 123 sedan and coupe

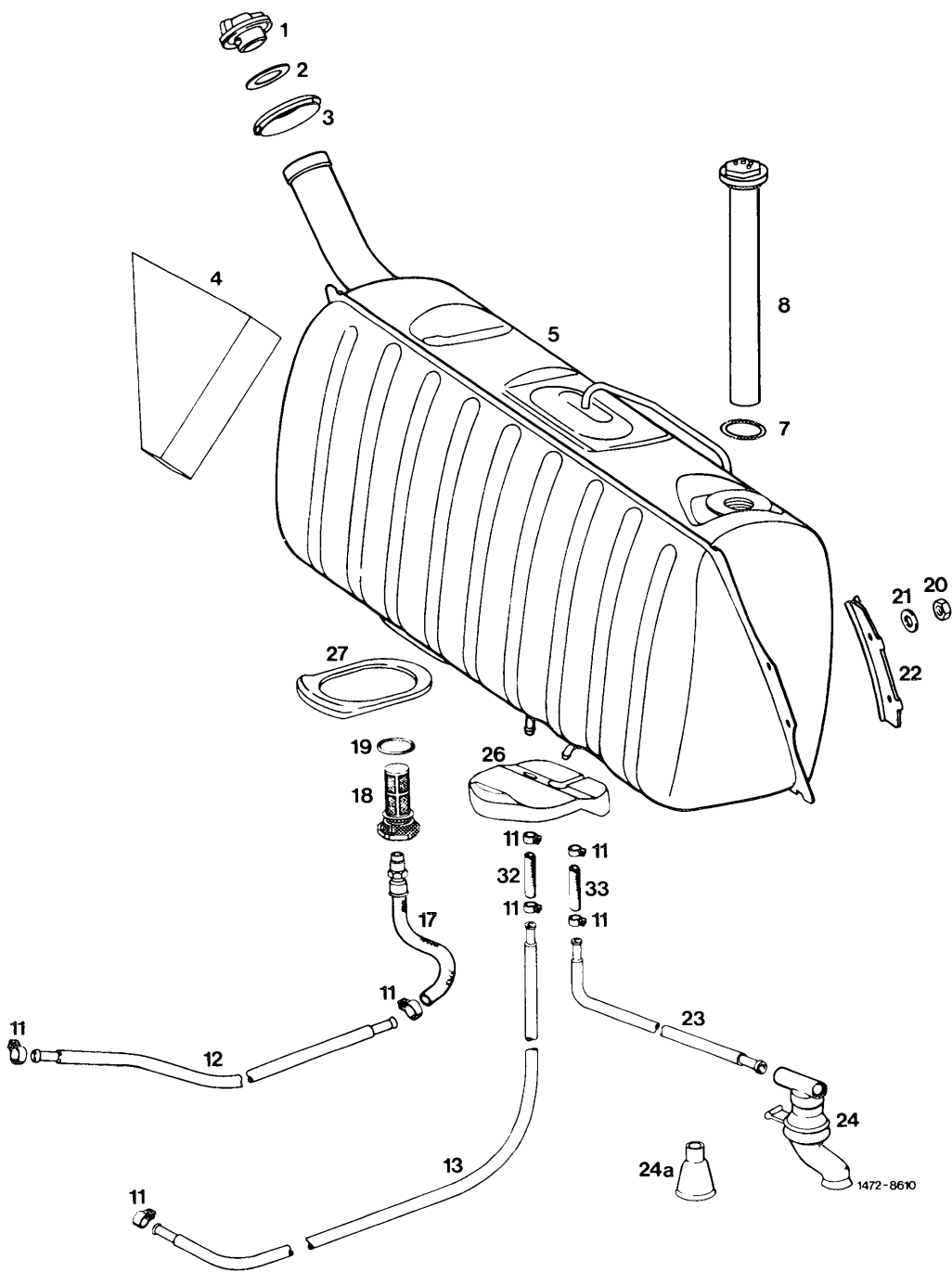

- | | | |
|---|----------------------------|-----------------------------|
| 1 Filler cap | 12 Fuel feed line | 23 Fuel tank vent line |
| 2 Seal | 13 Fuel return line | 24 Vent sleeve (version 2) |
| 3 Rubber sleeve | 17 Fuel suction hose | 24a Vent sleeve (version 1) |
| 4 Damping shim | 18 Fuel strainer | 26 Rubber gasket |
| 5 Fuel tank | 19 Sealing ring | 27 Rubber gasket |
| 7 Sealing ring | 20 Nut | 32 Fuel hose |
| 8 Immersion tube transmitter (screw-type) | 21 Washer | 33 Fuel hose |
| 11 Hose clamp | 22 Reinforcing sheet metal | |