

91-165 Removal and installation, reconditioning of folding armrest for driver's seat

Removal (up to 11/81)

- 1 Remove tensioning section of driver's seat backrest.
- 2 Unscrew nut (5) and remove toothed washer (4), unscrew screw (6).
- 3 Remove arm rest (3) from backrest frame.

- 3 Arm rest
- 4 Toothed washer
- 5 Nut
- 6 Screw

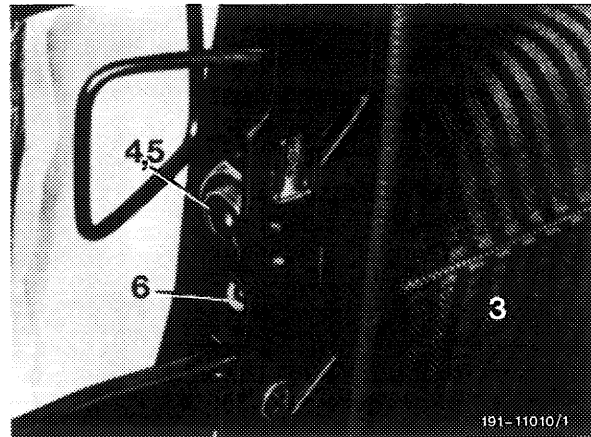

Removal (starting 12/81)

- 1 Remove tensioning section of driver's seat backrest.
- 2 Unscrew nut (5) and remove toothed washer (4).
- 3 Remove arm rest (3) from backrest frame.

Shown on model 126

- 3 Arm rest
- 4 Toothed washer
- 5 Nut

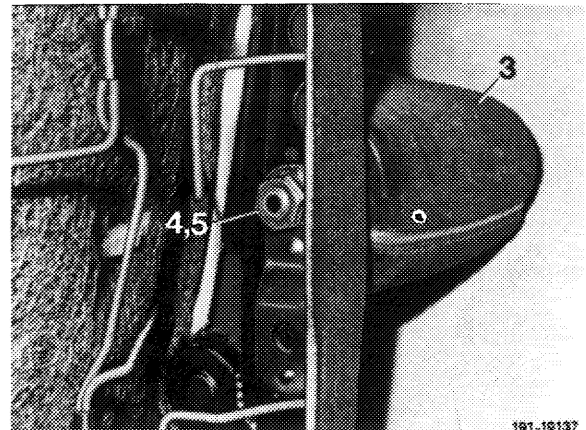

Installation

- 4 For installation proceed vice versa.

Reconditioning removed arm rest (up to 11/81)

- 1 Press off rosette at left and cover plate (9) at right.
- 2 Open zipper and remove covering.
- 3 Unscrew nuts (8), remove washers (7) with springs (6) and washers (5).
- 4 Remove bearing (4).
- 5 Take off washers (5).

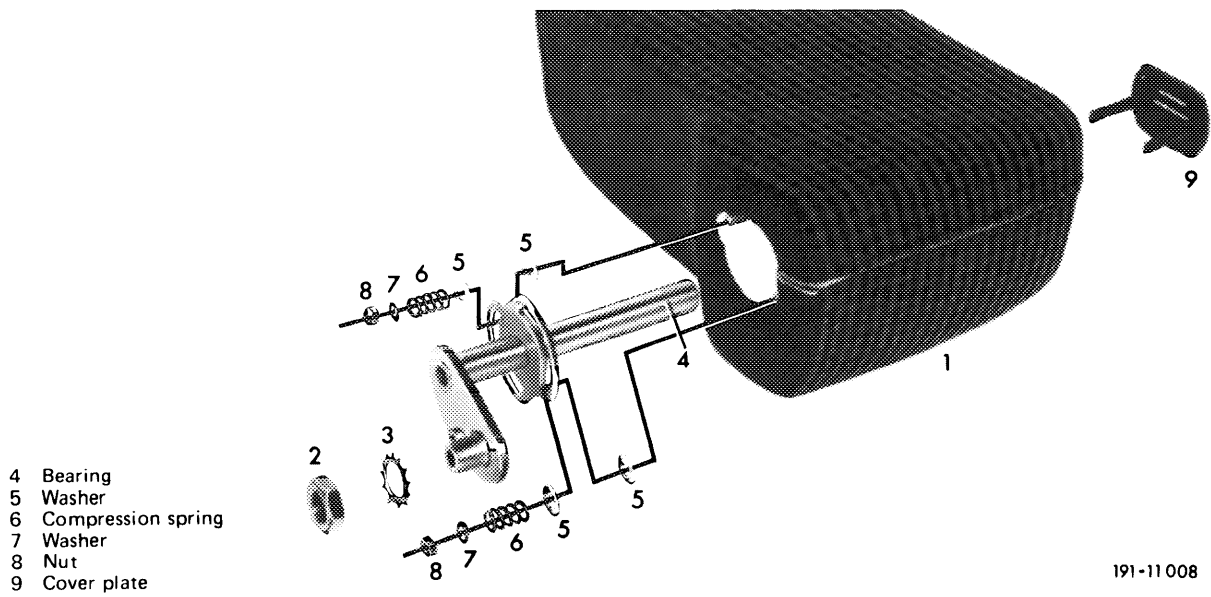

191-11 008

Assembling arm rest

- 6 For assembly proceed vice versa.

Reconditioning removed arm rest (starting 12/81)

1 Press off rosette.

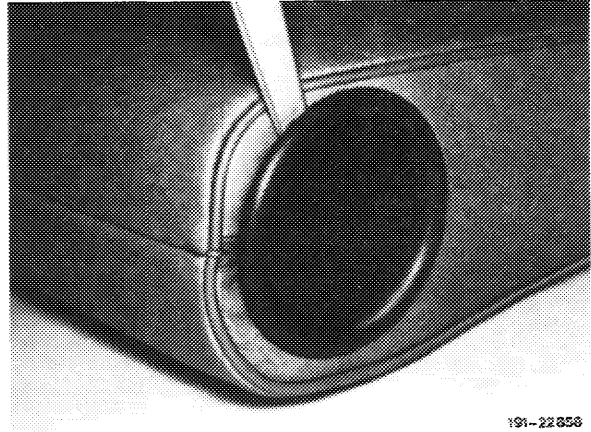

191-22856

2 Loosen covering, while cutting welded sealing strip at weld points and remove covering starting at one side.

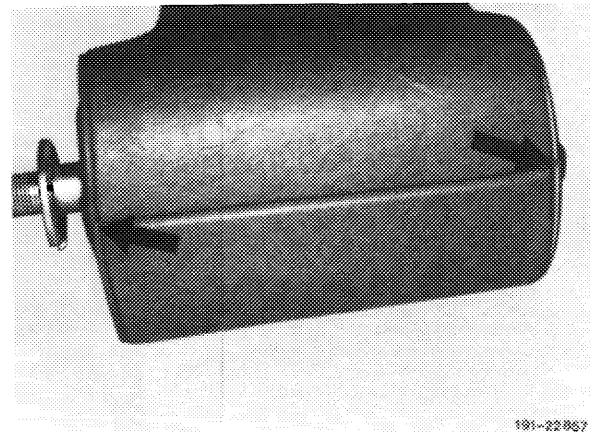

191-22857

4 Remove locks and detent rollers with actuating button pushed.

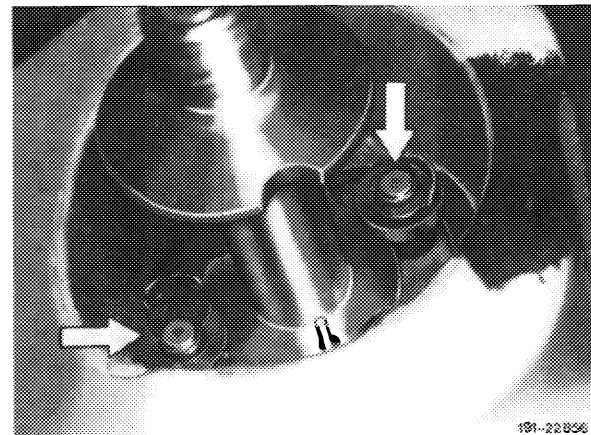

191-22858

5 Remove actuating button with springs and disassemble, if required.

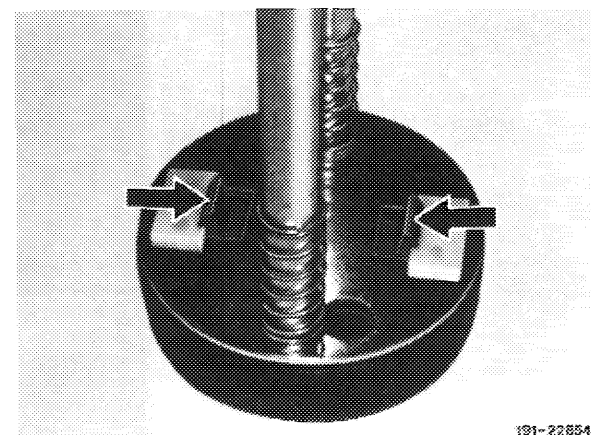

191-22854

6 Remove locking ring from bearing shaft and pull out bearing shaft with bushing.

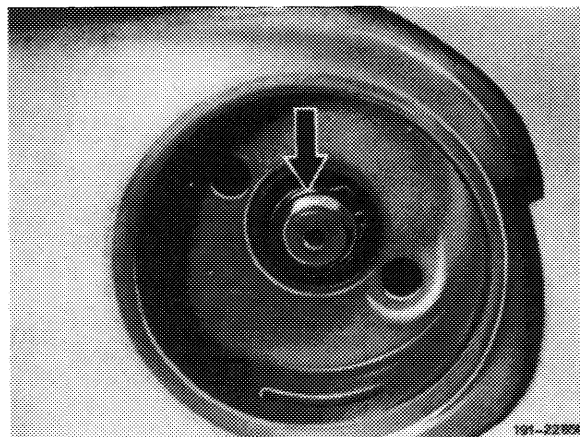

7 Remove buffer spring from bearing shaft.

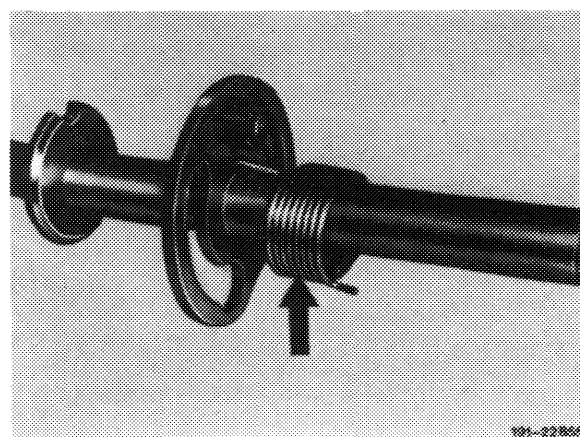

Assembling arm rest

8 For assembly proceed vice versa.

Note: In the event of repairs, sewing jobs on covering are performed laterally of sealing strip range.