

07.3—230 Removal and installation of throttle valve housing

Job No. of flat rates or standard texts and flat rates data 07—6210.

Note

Standard version

Starting April 1981 the throttle valve housing has been attached to the bottom section of the intake manifold with M6 bolt (hitherto M8).

Starting September 1981 the throttle valve housing has been modified as follows:

Bearing of throttle valve shaft in needle bearing.

Switchover valve for acceleration and full load enrichment.

Activation of EGR and of vacuum switch for idle speed and partial load identification.

- a To thermostable valve for EGR
- b To vacuum switch
- c To warm-up compensator — lower chamber
- d To 4-point distributor
- e To reservoir for full load enrichment

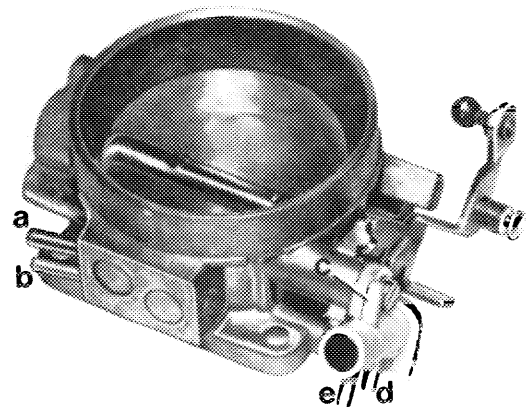

107-21700

Starting May 1983 connection "b" for vacuum switch is no longer installed. Instead, the throttle valve housing is provided with a throttle valve switch for idle speed and partial load identification.

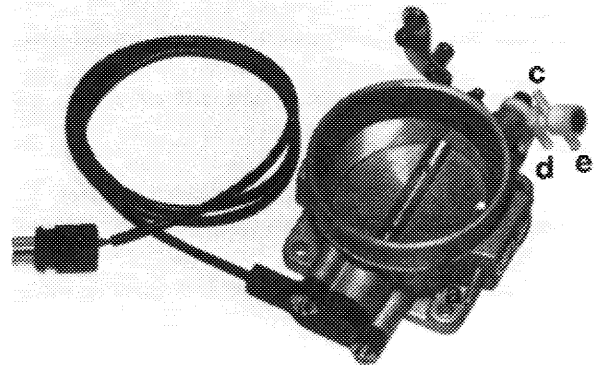

107-25806

Restoring spring

Engine 116.96 is provided with a reinforced restoring spring, part No. 116 993 17 10 since September 1980.

As from December 1981 engine 117.96 has a softer restoring spring, part No. 117 993 03 10. Wound length 60 mm (up to now 44 mm).

Material improvement of contour hoses (arrows) for 3/2-way valve on throttle valve housing.

Start of series: November 1982

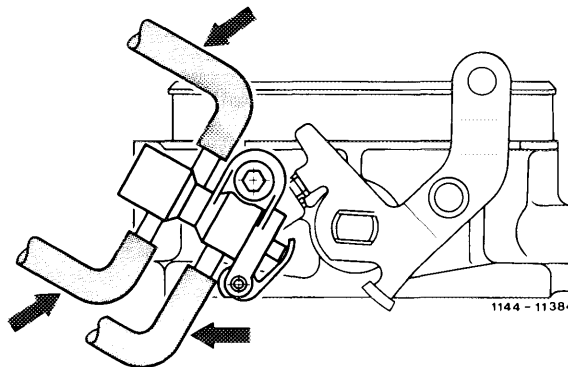

National version (J) (USA) **starting 1982**

Bearing of throttle valve shaft in needle bearing.

Throttle valve switch fastened with 2 fastening screws (1 up to now).

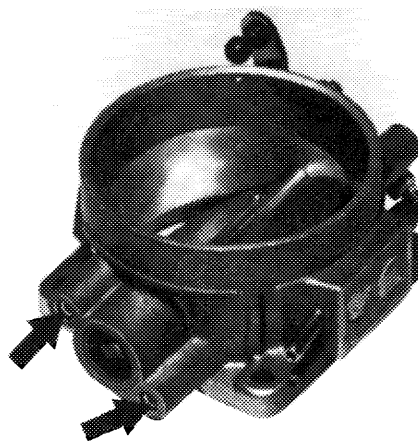

Removal

- 1 Remove mixture control unit with air guide housing (07.3-225).
- 2 Take off contour hose for idle speed adjuster. Slacken hose clip on throttle valve housing.
- 3 Disconnect regulating linkage and restoring spring.
- 4 Pull off vacuum connections.
- 5 Loosen fastening screws and remove throttle valve housing.

Installation

- 6 For installation proceed vice versa with new gasket.
- 7 Adjust regulating linkage (30–300).
- 8 Adjust ignition timing (firing point) (15–500).
- 9 Adjust idle speed (07.3–100).